

# Leica, the standard for individual solutions

## Leica Photoautomats & Digital Cameras

### Eyepieces

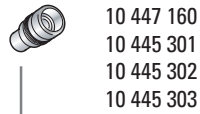

10 447 160  
10 445 301  
10 445 302  
10 445 303

### Tubes



10 445 619 45°



10 446 253 Ergo 45°

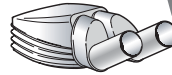

10 445 822 10 -50°

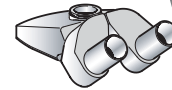

10 445 924/10 446 229 Video/Photo

### ErgoModules™



10 446 123 5°-25°

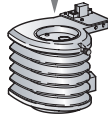

10 446 171  
30 - 120mm



10 446 180



Coaxial-Illuminator



10 446 093 / 10 446 143  
10 446 144 / 10 446 145  
10 446 146 / 10 446 147  
10 446 159 / 10 446 234  
Fluorescence modules

### Optics carriers

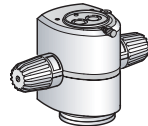

10 446 371 MZ7s

### Objectives



10 411 589 1x  
10 422 562 1.5x  
10 422 561 2x  
10 473 832 0.8x  
10 445 201 0.63x  
10 422 563 0.5x  
10 422 564 0.32x  
Achromatic



10 446 275 1x  
Plan



10 446 172



10 446 157 0.5x Plan  
10 447 075 0.8x Plan  
10 447 157 1x Planapo  
10 447 101 2x Planapo  
10 447 050 1.6x Planapo  
10 446 236 0.63x Planapo  
Plan/Planapo



10 447 148  
Ergo 0.4x - 0.63x

### Microscope carriers

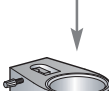

10 445 617



10 445 618 AX

### Focusing drive with column

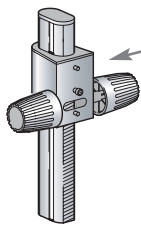

10 445 615 (300mm)  
10 446 100 (500mm)

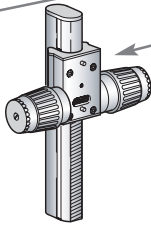

10 447 106 / 10 447 185  
Coarse/Fine

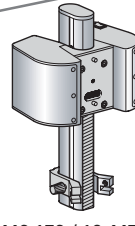

10 446 176 / 10 447 041  
Motorfocus

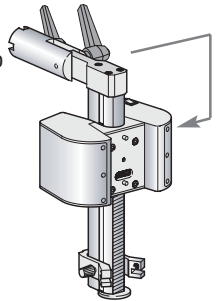

10 446 259  
Motorfocus for swing-arm

### Stands

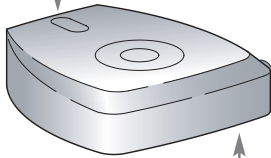

10 445 367 HL  
10 446 359 HL RC™  
Transmitted-light

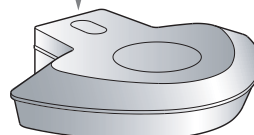

10 445 387 BF  
10 445 363 BF / DF

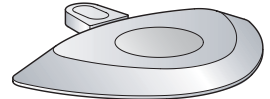

10 445 631  
Incident-light

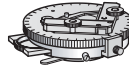

10 368 078  
Polarization